

Instructional Guide

*Supplemental Hardware Kit
63-67 C2 Corvette*

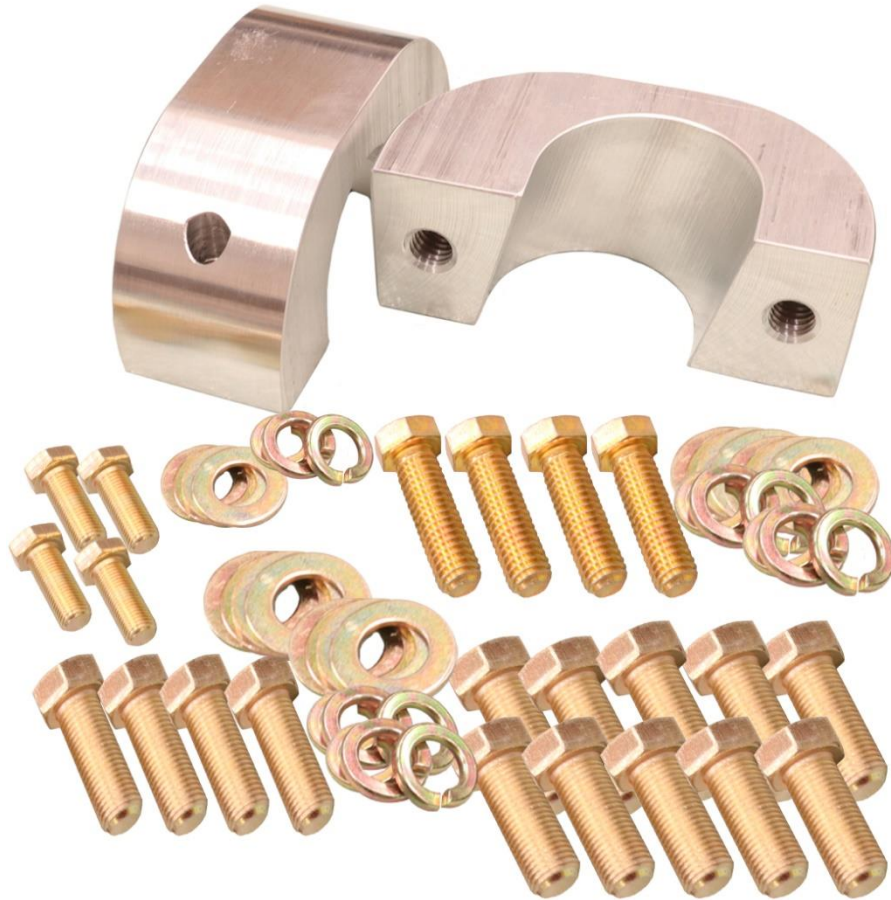

Speedtech
PERFORMANCE

CHASSIS - SUSPENSION - PRO TOURING - AUTOCROSS - DRAG RACING - CUSTOM BUILDS

435.628.4300 SPEEDTECHPERFORMANCE.COM    

4160 S. RIVER RD, ST. GEORGE, UT 84790



Figure 1 C2 Corvette, features our ExtReme IRS Chassis

Congratulations on the purchase of your new Speedtech Performance Supplemental Hardware Kit. Use only approved and appropriately rated jack and jack stands, be sure to take all safety precautions required to do the job safely and correctly. If you are unsure, seek the assistance of a highly qualified workshop to assist you.

Read and understand all instructions thoroughly before you begin. For the most part, assembly and set up of your new Supplemental Hardware Kit can be done in a home garage with hand tools and basic equipment.

We enjoy seeing the progress our customers are making as they work through their builds so join the Team Speedtech group on Facebook and share your pictures and your story.

From everyone at Speedtech Performance we send you all best wishes for your project!

Installation Guide

TABLE OF CONTENTS

1. GENERAL INFORMATION

- 1.1 THIS GUIDE
- 1.2 OVERVIEW
- 1.3 TOOLS

2. CHECK IN PARTS AND HARDWARE

- 2.1 CHECKING IN THE ORDER
- 2.2 CHECK IN TABLES

3. GETTING STARTED/INSTALLATION

- 3.1 LEVELING AND SUPPORT
- 3.2 INSTALLATION

4. FINISHING

- 4.1 TORQUE

5. CONGRATULATIONS

1.0 GENERAL INFORMATION

[Back to Table to Contents](#)

1.1 This Guide

Thank you for purchasing your new Speedtech Performance Supplemental Hardware Kit. These instructions outline the Supplemental Hardware Kit that will be installed with the Speedtech Performance ExtReme chassis only.

1.2 Tools

Installation of the Speedtech Performance Supplemental Hardware Kit can be done on the floor with simple hand tools.

Additional things to have before you start:

- Wrench
- Jack Stands
- Anti-Seize
- Post Lift (If possible)
- Angle Grinder / Cut-Off wheel

2.0 CHECK IN PARTS AND HARDWARE

[Back to Table to Contents](#)

2.1 Checking in the Order

Best practice will be to check in your order as soon as possible after receiving the order. To check in the order we have provided tables, these can be used as check lists for your order.

2.2 Check in Tables

X	#	Description	Size
	2	Bumper Mount Support Clamp	C2
	4	Hex Cap Screw	7/16 x 1 1/2 NC
	4	Hex Cap Screw	7/16 x 1 1/4 NF
	10	Hex Cap Screw	1/2 x 1 1/4 NF
	4	Hex Cap Screw	3/8 x 1 NF
	10	Washer – Flat	1/2
	8	Washer – Flat	7/16
	4	Washer – Flat	3/8
	8	Washer – Lock	7/16
	10	Washer – Lock	1/2
	4	Washer – Lock	3/8

Note: There may be some extra hardware that was packaged that is not accounted for in the check list. The hardware kits are made to fit multiple products and the excess is from that process.

3.0 GETTING STARTED / INSTALLATION

[Back to Table to Contents](#)

3.1 LEVELING AND SUPPORT

The vehicle should be on a level surface before you start.

3.2 INSTALLATION

SEE THE DIAGRAMS ON THE FOLLOWING PAGES.

NOTE: Ensure the body is square on the chassis during the mounting process.

NOTE: You may need additional shims, due to years of use and variations on your individual vehicle.

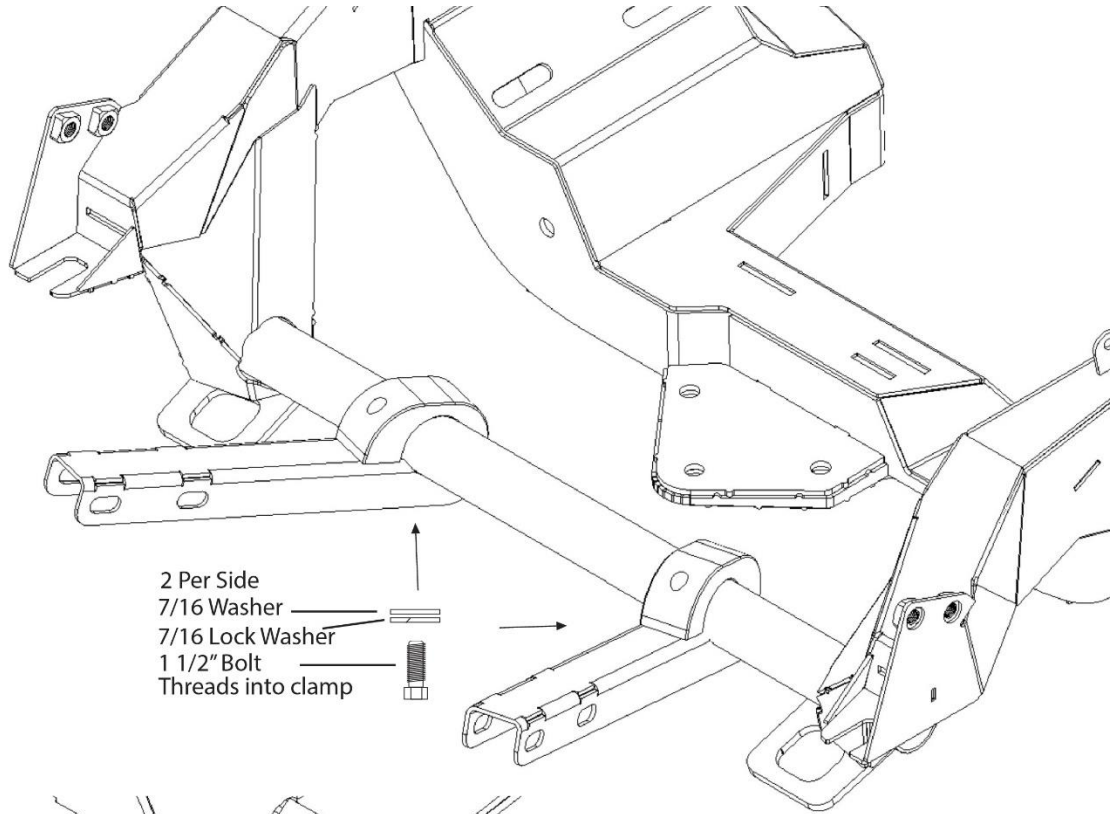

- 2 Per Side
- 7/16 Washer
- 7/16 Lock Washer
- 1 1/2" Bolt
- Threads into clamp

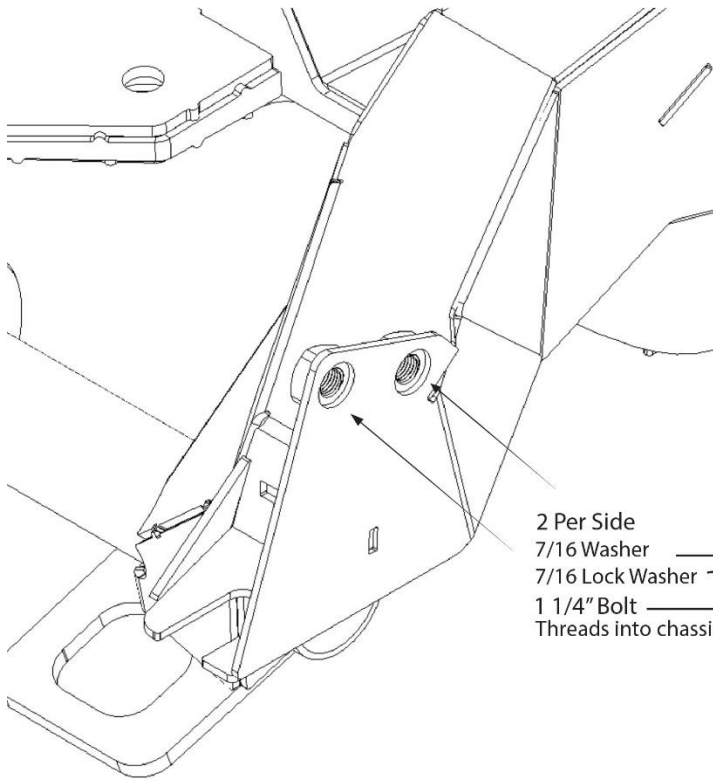



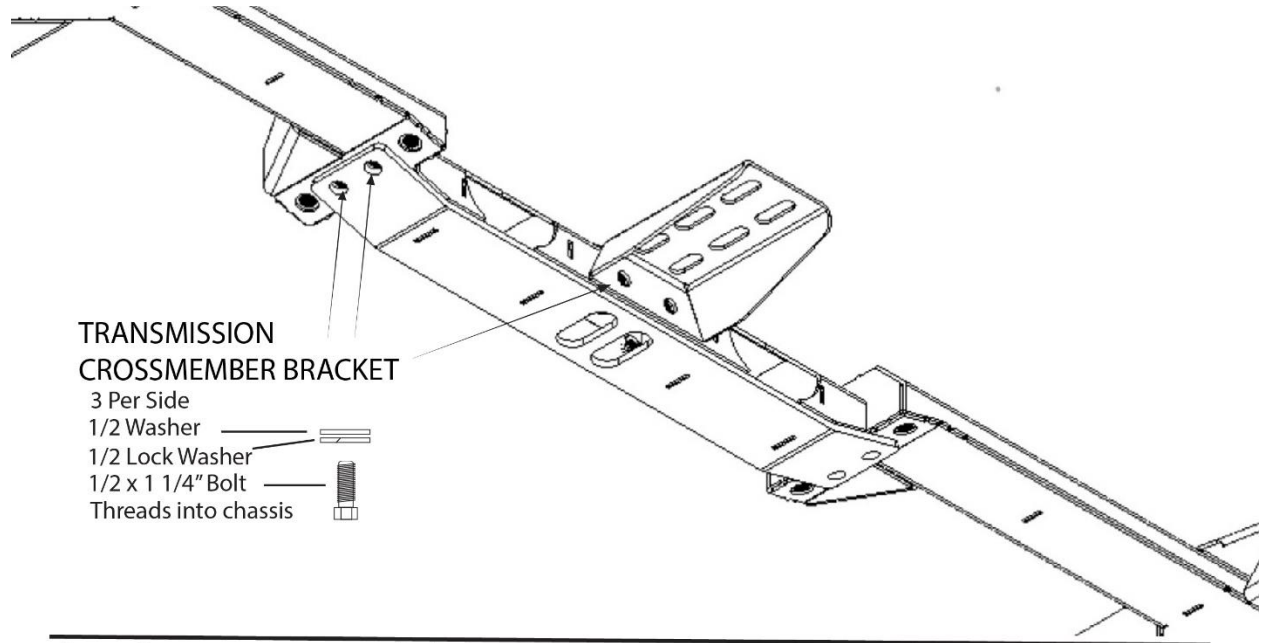

You will have to modify the stock bracket.
 The rear of the bracket will have to be trimmed.
 You will have to drill another hole in the rear
 of the bracket.

- 2 Per Side
- 7/16 Washer
- 7/16 Lock Washer
- 1 1/4" Bolt
- Threads into chassis





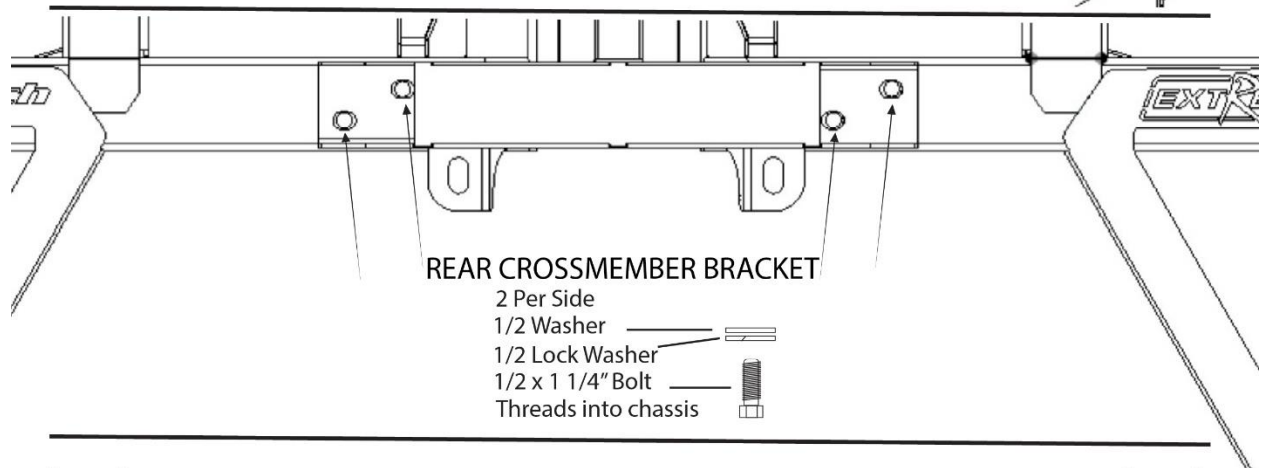

**TRANSMISSION
CROSSMEMBER BRACKET**

- 3 Per Side
- 1/2 Washer 
- 1/2 Lock Washer 
- 1/2 x 1 1/4" Bolt 
- Threads into chassis 





REAR CROSSMEMBER BRACKET

- 2 Per Side
- 1/2 Washer 
- 1/2 Lock Washer 
- 1/2 x 1 1/4" Bolt 
- Threads into chassis 

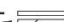
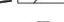

GAS TANK STRAP

- 2 Per Side
- 3/8 Washer 
- 3/8 Lock Washer 
- 3/8 x 1" Bolt 
- Threads into chassis 

4.0 FINISHING

[Back to Table to Contents](#)

4.1 TORQUE

As each vehicle may be slightly different, be sure to ensure square during the process. You will want all to make sure bumper brackets are all true, and may have to shim as needed. When the frame is squared in, **torque all bolts.**

TORQUE VALUES

X	#	Description	Size	FT/LBS
	4	Hex Cap Screw	7/16 x 1 1/2 NC	52
	4	Hex Cap Screw	7/16 x 1 1/4 NF	58
	10	Hex Cap Screw	1/2 x 1 1/4 NF	90
	4	Hex Cap Screw	3/8 x 1 NF	37

NOTE: Recheck torque after approximately 100 miles of driving.

5.0 Congratulations

[Back to Table to Contents](#)

Congratulations on completing your project, we know you will get many years of enjoyment from your project. Please join the group [Team Speedtech](#) on Facebook. Team Speedtech is a community of like-minded individuals using Speedtech Performance products. The Group's members include customers, our dealers and factory employees - each with a passion for Pro Touring muscle cars. You can ask questions and get advice from the group members as well as share your experience. Within the group we enjoy seeing the videos and pictures during the progress of your projects so post up. We also encourage you to share pictures and videos of your finished projects out on the road, at the show & shine, on track or however you get enjoyment from your ride, we want to see it!

Thank you for choosing Speedtech Performance! We know you have a choice, and we appreciate that you entrust us with your chassis and suspension needs for you custom muscle cars.

Speedtech Performance, LLC
4160 S. River Rd.
St George UT, 84770
(435) 628-4300