

# Instructional Guide

*3<sup>rd</sup> Gen Hemi Engine Mount Adaptors*



***Speedtech***  
**PERFORMANCE**

CHASSIS - SUSPENSION - PRO TOURING - AUTOCROSS - DRAG RACING - CUSTOM BUILDS

435.628.4300 [SPEEDTECHPERFORMANCE.COM](http://SPEEDTECHPERFORMANCE.COM)    

4160 S. RIVER RD, ST. GEORGE, UT 84790

## Revision Sheet

Release No.	Date	Revision Description
Rev. 0	8/9/22	Created - CF
Rev. 1		
Rev. 2		
Rev. 3		

<p style="text-align: center;"><b>Installation Guide Approval Memorandum</b></p>
--

I have carefully assessed the Installation Guide. This document has been completed in accordance with the expectations as follows.

APPROVAL - Please initial the appropriate statement.

\_\_\_\_\_ Engineering: The document is accepted pending the changes noted.

\_\_\_\_\_ Workshop: The document is accepted pending the changes noted.

\_\_\_\_\_ The document is not accepted.



*Figure 1 1970 AAR Cuda, features our ExtReme Subframe and IRS, Ken Kelley*

Congratulations on the purchase of your new Speedtech Hemi Engine Adaptor Plate. Use only approved and appropriately rated jack and jack stands, be sure to take all safety precautions required to do the job safely and correctly. If you are unsure, seek the assistance of a highly qualified workshop to assist you.

Read and understand all instructions thoroughly before you begin. For the most part, assembly and set up of your new Hemi Engine Adaptor Plate can be done in a home garage with hand tools and basic welding equipment.

We enjoy seeing the progress our customers are making as they work through their builds so join the Team Speedtech group on Facebook and share your pictures and your story.

From everyone at Speedtech Performance we send you all best wishes for your project!

---

# Installation Guide

## TABLE OF CONTENTS

### 1. GENERAL INFORMATION

- 1.1 THIS GUIDE
- 1.2 TOOLS

### 2. CHECK IN PARTS AND HARDWARE

- 2.1 CHECKING IN THE ORDER
- 2.2 CHECK IN TABLES

### 3. GETTING STARTED/INSTALLATION

- 3.1 POLY MOUNT PREP
- 3.2 BLOCK INSTALL

### 4. CONGRATULATIONS

## 1.0 GENERAL INFORMATION

[Back to Table to Contents](#)

### 1.1 This Guide

Thank you for purchasing your new Speedtech Performance Hemi Engine Adaptor Plate. These instructions outline the Hemi Engine Adaptor Plate that will be installed with the Mopar E or B-Body ExtReme suspension. Take all necessary precautions whenever doing this type of work and use safe and sturdy jack stands to support the vehicle whenever it is off the ground. Be sure to take all other safety precautions required to do the job correctly. The following instructions are intended for professional installers and are guidelines only. Speedtech Performance assumes NO responsibility for the installation of any of its products. All products must be installed by qualified professionals only.

### 1.2 Tools

Installation of the Speedtech Performance Hemi Engine Adaptor Plate can be done on the floor with simple hand tools.

Additional things to have before you start:

- Socket Set
- Allen Wrench
- Blue Locktite

## 2.0 CHECK IN PARTS AND HARDWARE

[Back to Table to Contents](#)

### 2.1 Checking in the Order

Best practice will be to check in your order as soon as possible after receiving the order. To check in the order we have provided tables, these can be used as check lists for your order.

### 2.2 Check in Tables

X	#	Description	Size
	2	Engine Mount Adaptor Plate	
	4	Engine Mount Hex Bolt	3/8 x 3/4 NC
	4	Engine Mount Washer	3/8
	8	Engine Block Sock Head Bolt	M10-30 SCHS
	8	Engine Block Washer	M10



### 3.0 GETTING STARTED / INSTALLATION

[Back to Table to Contents](#)

#### 3.1 POLY MOUNT PREP

- Locate the (4) mount hex bolts.
  - Apply blue Loctite to the bolts.
- Bolt the poly mount onto the plate using 2 out of the 3 holes.
  - Thread into the tapered places with the prepared bolts and washers.
  - Torque to 35 ft.lb

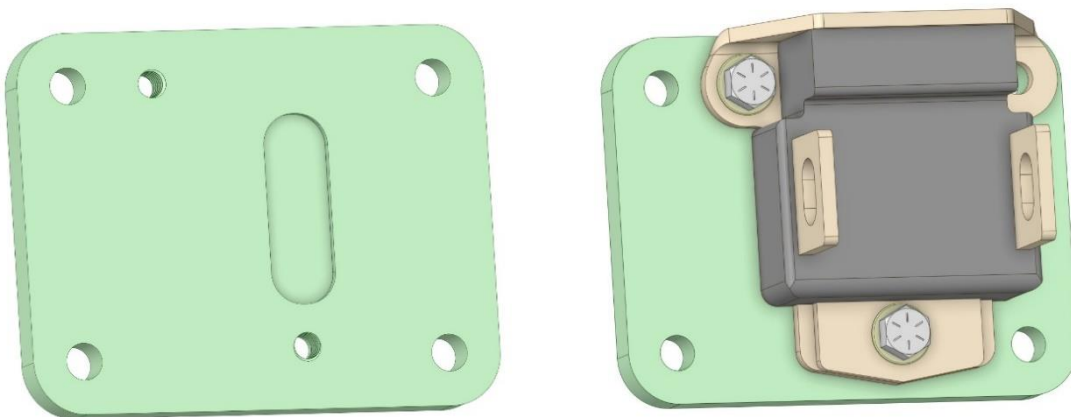

## 3.2 BLOCK INSTALL

- Orient the adaptor plates onto their respected sides of the Hemi Block.
  - On the driver side, the poly mount will be towards the back.
  - On the passenger side, the poly mount will be towards the front.
- Install the adaptor plates using the (8) M10-30 bolts and (8) washers.
  - On final assembly, use blue Loctite.
  - Torque to 35 ft.lb.

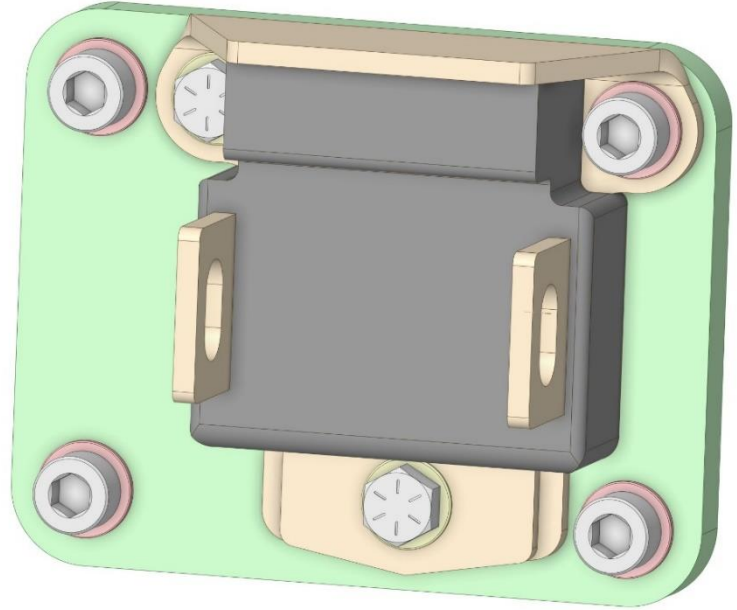

**NOTE:** The poly mounts are spaced differently from passenger to driver measuring from the front of the crank. Keep this in mind when installing the motor into the ExtReme frame. The engine stands are adjustable on the crossmember and will also be uneven between the sides of the car.

## 4.0 CONGRATULATIONS

[Back to Table to Contents](#)

Congratulations on completing your project, we know you will get many years of enjoyment from your project. Please join the group [Team Speedtech](#) on Facebook. Team Speedtech is a community of like-minded individuals using Speedtech Performance products. The Group's members include customers, our dealers and factory employees - each with a passion for Pro Touring muscle cars. You can ask questions and get advice from the group members as well as share your experience. Within the group we enjoy seeing the videos and pictures during the progress of your projects so post up. We also encourage you to share pictures and videos of your finished projects out on the road, at the show & shine, on track or however you get enjoyment from your ride, we want to see it!

Thank you for choosing Speedtech Performance! We know you have a choice, and we appreciate that you entrust us with your chassis and suspension needs for you custom muscle cars.

Speedtech Performance, LLC  
4160 S. River Rd.  
St George UT, 84770  
(435) 628-4300