

Instruction Guide

3rd Gen Hemi Engine Mount Adaptors



Speedtech
PERFORMANCE

CHASSIS - SUSPENSION - PRO TOURING - AUTOCROSS - DRAG RACING - CUSTOM BUILDS

435.628.4300 SPEEDTECHPERFORMANCE.COM



4160 S. RIVER RD, ST. GEORGE, UT 84790



Figure 1: 1970 AAR Cuda, features our ExtReme Subframe and IRS [photo by Ken Kelley]

Congratulations on the purchase of your new Speedtech Performance hemi engine mount adapters. Use only approved and appropriately rated jack and jack stands, and be sure to take all safety precautions required to complete the job safely and correctly. If you have uncertainties, seek the assistance of a highly qualified workshop to assist you.

Read and understand all instructions thoroughly before you begin. Your main assembly and set up of your new hemi engine mount adapters can be done in a home garage with hand tools.

Speedtech enjoys seeing the progress our customers are making as they work through their builds. Join the group, [Team Speedtech](#), on Facebook and share your pictures and your story.

Speedtech Performance sends you best wishes for your project!

TABLE OF CONTENTS

1.0	GENERAL INFORMATION.....	4
1.1	THIS GUIDE.....	4
1.2	OVERVIEW.....	4
1.3	TOOLS.....	4
2.0	CHECK IN PARTS AND HARDWARE.....	4
2.1	CHECKING IN THE ORDER.....	4
2.2	CHECK IN TABLE.....	4
3.0	GETTING STARTED / INSTALLATION.....	5
3.1	POLY MOUNT PREPERATION.....	5
3.2	BLOCK INSTALL.....	6
4.0	CONGRATULATIONS.....	6

1.0 GENERAL INFORMATION

[Back to Table of Contents](#)

1.1 THIS GUIDE

Thank you for purchasing your new Speedtech Performance hemi engine mount adapters. Read through all instructions thoroughly before beginning and take all safety precautions required to do the job carefully and correctly.

Speedtech Performance assumes NO responsibility for the installation of any of its products. All products must be installed by qualified professionals only.

1.2 OVERVIEW

These instructions outline the Hemi Engine Adaptor Plate that will be installed with the Mopar E or B-Body ExtReme suspension. Photos in the instruction process may vary slightly from your exact operation.

1.3 TOOLS

Installation of the Speedtech Performance hemi engine adaptor plate can be done on the floor with simple hand tools.

Additional things to have before you start:

- Socket Set
- Allen Wrench
- Blue Locktite

2.0 CHECK IN PARTS AND HARDWARE

[Back to Table of Contents](#)

2.1 CHECKING IN THE ORDER

Check in your order as soon as possible. To check in the order, Speedtech has provided a table which can be used as a check list, as displayed in figure 2. All bolts and nuts are NF unless otherwise noted. Hardware comes in several boxes. If you discover anything missing from your order, call your authorized dealer as soon as possible.

2.2 CHECK IN TABLE

X	#	Description	Size
	2	Engine Mount Adaptor Plate	
	4	Engine Mount Hex Bolt	3/8 x 3/4 NC
	4	Engine Mount Washer	3/8
	8	Engine Block Sock Head Bolt	M10-30 SCHS
	8	Engine Block Washer	M10

Figure 2: Check in table with amounts, descriptions, and sizes



Figure 3: Parts and hardware

3.0 GETTING STARTED / INSTALLATION

[Back to Table of Contents](#)

3.1 POLY MOUNT PREPERATION

- Locate the (4) mount hex bolts.
 - Apply blue Loctite to the bolts.
- Bolt the poly mount onto the plate using two out of the three holes.
 - Thread into the tapered places with the prepared bolts and washers.
 - Torque to 35 ft.lb.

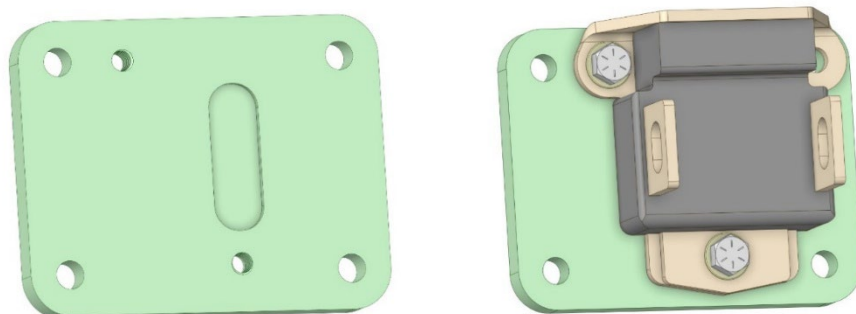

Figure 4: Poly mount preparation

3.2 BLOCK INSTALL

- Orient the adaptor plates onto their respected sides of the hemi block.
 - On the driver side, the poly mount will be towards the back.
 - On the passenger side, the poly mount will be towards the front.
- Install the adaptor plates using the (8) M10-30 bolts and (8) washers.
 - On final assembly, use blue Loctite.
 - Torque to 35 ft.lb.

NOTE: The poly mounts are spaced differently from passenger to driver measuring from the front of the crank. Keep this in mind when installing the motor into the ExtReme frame. The engine stands are adjustable on the crossmember and will also be uneven between the sides of the car.

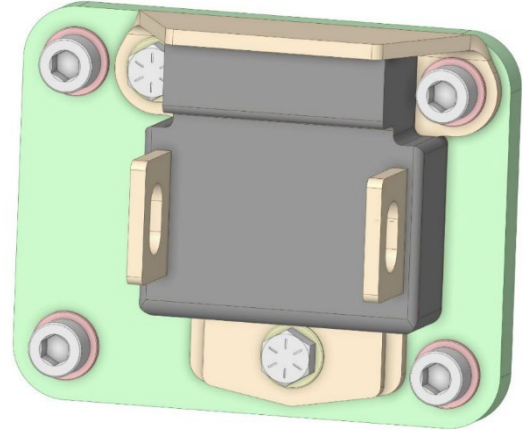

Figure 4: Block install and finished assembly

4.0 CONGRATULATIONS

[Back to Table of Contents](#)

Congratulations on completing your project! We know you will get many years of enjoyment from your project. Please join the group, [Team Speedtech](#), on Facebook. Team Speedtech is a community of customers, dealers, and factory employers that have a passion for pro touring muscle cars and are using Speedtech Performance products. You can ask questions and get advice from the group members and share your experience. Everyone enjoys seeing the videos and pictures during the progress of your project and Speedtech encourages you to share them!

Thank you for choosing Speedtech Performance and entrusting us with your hemi engine plate for your custom muscle car.

Speedtech Performance, LLC
4160 S. River Rd.
St George UT, 84770
(435) 628-4300