

Instruction Guide

Smooth Firewall
67-69 F-Body / 68-74 X-Body

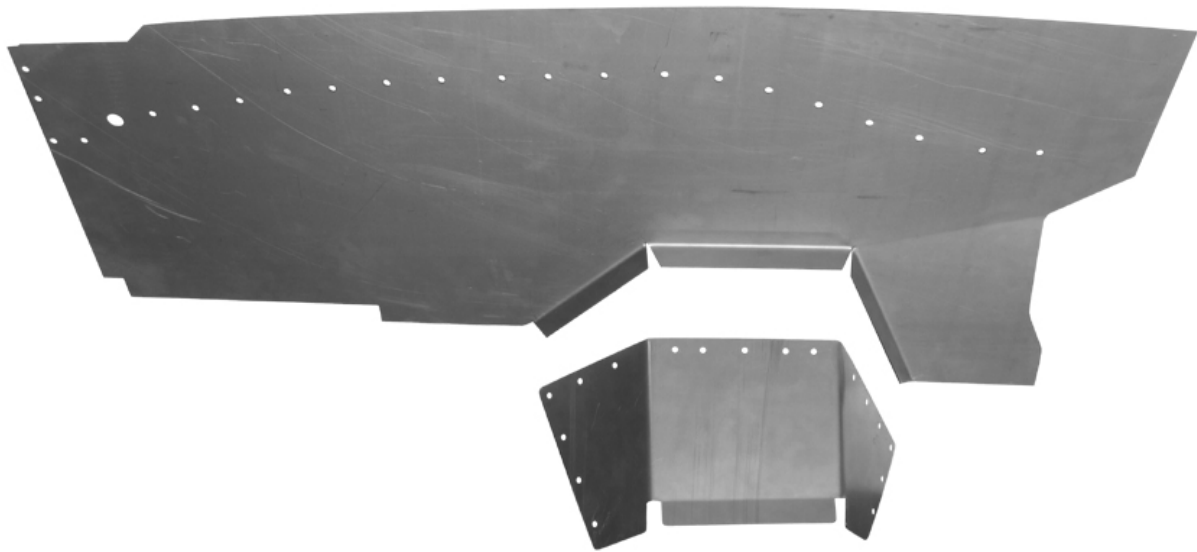

Speedtech
PERFORMANCE

CHASSIS - SUSPENSION - PRO TOURING - AUTOCROSS - DRAG RACING - CUSTOM BUILDS

435.628.4300 SPEEDTECHPERFORMANCE.COM    

4160 S. RIVER RD, ST. GEORGE, UT 84790



Figure 1: 1968 Camaro Phat 68 features our ExtReme subframe and torque arm suspension [photo by Michael Cuthbertson]

Congratulations on the purchase of your new Speedtech Performances smooth firewall. Use only approved and appropriately rated jack and jack stands, and be sure to take all safety precautions required to complete the job safely and correctly. If you have uncertainties, seek the assistance of a highly qualified workshop to assist you.

Read and understand all instructions thoroughly before you begin. Your main assembly and set up of your new smooth firewall can be done in a home garage with hand tools and basic welding equipment.

Speedtech enjoys seeing the progress our customers are making as they work through their builds. Join the group, [Team Speedtech](#), on Facebook and share your pictures and your story.

Speedtech Performance sends you best wishes for your project!

TABLE OF CONTENTS

1.0	GENERAL INFORMATION.....	4
1.1	THIS GUIDE.....	4
1.2	OVERVIEW.....	4
1.3	TOOLS.....	5
2.0	CHECK IN PARTS AND HARDWARE.....	5
2.1	CHECKING IN THE ORDER.....	5
2.2	CHECK IN TABLE.....	5
3.0	GETTING STARTED.....	5
3.1	LEVELING AND SUPPORT.....	5
4.0	CUTTING/REMOVAL.....	6
4.1	MOCK UP AND REMOVAL.....	6
4.2	SPOT WELD REMOVAL.....	7
4.3	CUTTING FIREWALL.....	7
5.0	INSTALLATION.....	7
5.1	MOCK UP - FIREWALL.....	7
5.2	MOCK UP - TUNNEL.....	7
5.3	WELDING.....	8
6.0	CONGRATULATIONS.....	9

1.0 GENERAL INFORMATION

[Back to Table of Contents](#)

1.1 THIS GUIDE

Thank you for purchasing your new Speedtech Performance smooth firewall. Read through all instructions thoroughly before beginning and take all safety precautions required to do the job carefully and correctly. If you have uncertainty, seek the assistance of a highly qualified workshop.

The following instructions are intended for professional installers and are guidelines only. Speedtech Performance assumes no responsibility for the installation of any of its products installed by others. All products are intended to be installed by qualified professionals.

NOTE: Some items pictured may look different than the parts you received in the kit. For example, in this guide we have only used pictures of the smooth firewall for the early Camaro. Your application may have a slightly different shape; the part is functionally the same and is installed in the same manner described.

1.2 OVERVIEW

These instructions outline the smooth firewall.

Take necessary precautions when welding the inside of your vehicle and remove any close-by flammable materials including the seats, carpet, inner heater box, and insulation padding before performing this instruction. Be sure to wear proper protective gear when using power tools and keep sparks away from glass and other interior components when grinding and welding.

This install is not intended for the entry level garage builder. This firewall kit requires a higher level of fabrication experience and skills. It also requires the ability to think through the process while filling in any gaps that the instructions may not cover. It can be installed with basic hand and power tools, and requires welding. If you are unsure of how to use the tools and materials, and carryout the fabrication work required to install this kit, stop and seek a professional installer's help.

NOTE (for before you begin cutting): The firewall is a major structural part of the car's body. Modifying the structural integrity of a vehicle may cause the body to become flimsy and shift while you are working on it. Speedtech recommends installing temporary bracing to hold the car's shape. For example, you can install a brace and weld in from the front kick panel area to the base of the transmission tunnel. The installer should be able to make good judgment of how and where to do this. If you are also installing the Camaro part # 11510 or Nova part # 121510 transmission tunnel cover kit, Speedtech recommends completing one kit at a time so that one area will help maintain structural integrity while the other area is being modified. Do not cut out the firewall and transmission tunnel at the same time.

If you need help or insight on this install, do not hesitate to contact Speedtech.

1.3 TOOLS

Installation of the Speedtech Performance smooth firewall can be done on the floor with a cut off wheel, basic welder, and simple hand tools.

Additional things to have before you start:

- Drill
- Floor Stands
- Floor Jack
- Welder
- Grinder

2.0 CHECK IN PARTS AND HARDWARE

[Back to Table of Contents](#)

2.1 CHECKING IN THE ORDER

Check in your order as soon as possible. To check in the order, Speedtech has provided a table which can be used as check list, as displayed in figure 2. All bolts and nuts are NF unless otherwise noted. Hardware comes in several boxes. If you discover anything missing from your order, call your authorized dealer as soon as possible.

2.2 CHECK IN TABLE

BRACING

X	#	Description	Size
	1	Smooth Firewall	
	1	Tunnel Transition Piece	

Figure 2: Table with the amount and description of parts

3.0 GETTING STARTED

[Back to Table of Contents](#)

3.1 LEVELING AND SUPPORT

WARNING: The vehicle should be on a level surface before you start.

First, jack up and properly support the vehicle's frame. Next, remove the front wheels. For cars with drop off style rotors, reinstall one lug nut if needed to prevent the rotor from falling off.

3.2 DISCONNECT THE BATTERY

Since you will be cutting and welding the firewall, floor, and tunnel of the car, disconnect the battery.

4.0 CUTTING/REMOVAL

[Back to Table of Contents](#)

4.1 MOCK UP AND REMOVAL

Place the smooth firewall up against the factory firewall to become familiar with its fitment.

NOTE: Some areas may need to be trimmed for best fit. Mark the outside perimeter of the new firewall onto the factory firewall. Moving inward around 1/2 - 3/4" draw a parallel perimeter line on the factory firewall for your cut guide line. This image depicts how the firewall fits on the factory wall. The blacked-out area represents what will be removed.

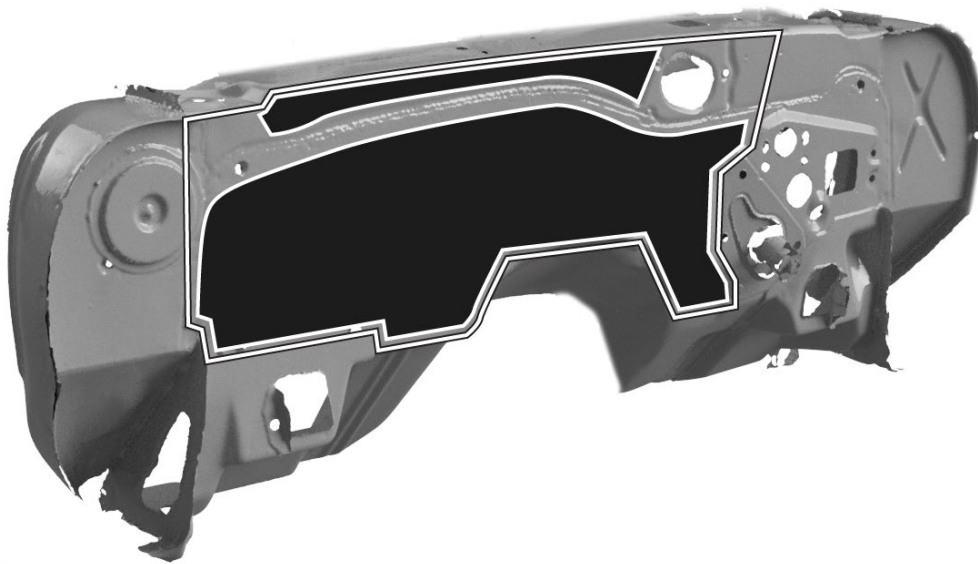

Figure 3: Marks and cut outs on the firewall

NOTE: At (A.) the old firewall creates a natural ledge for the new firewall to mate to.

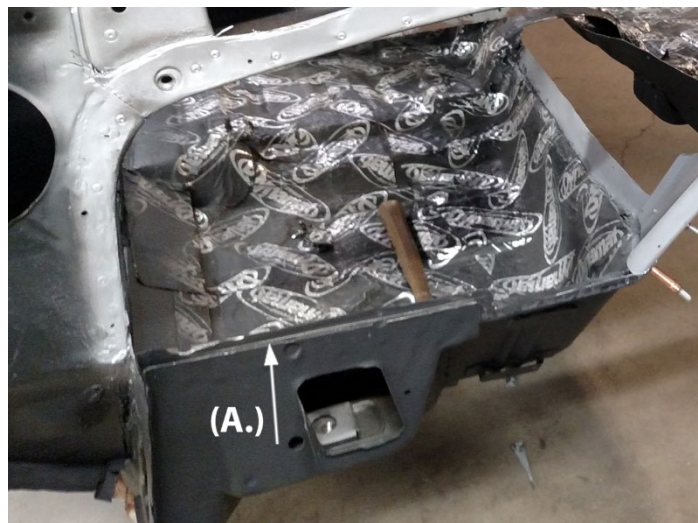

Figure 4: A. of the old firewall

4.2 SPOT WELD REMOVAL

Locate and drill out the spot welds across the firewall junction as seen in the outline below.

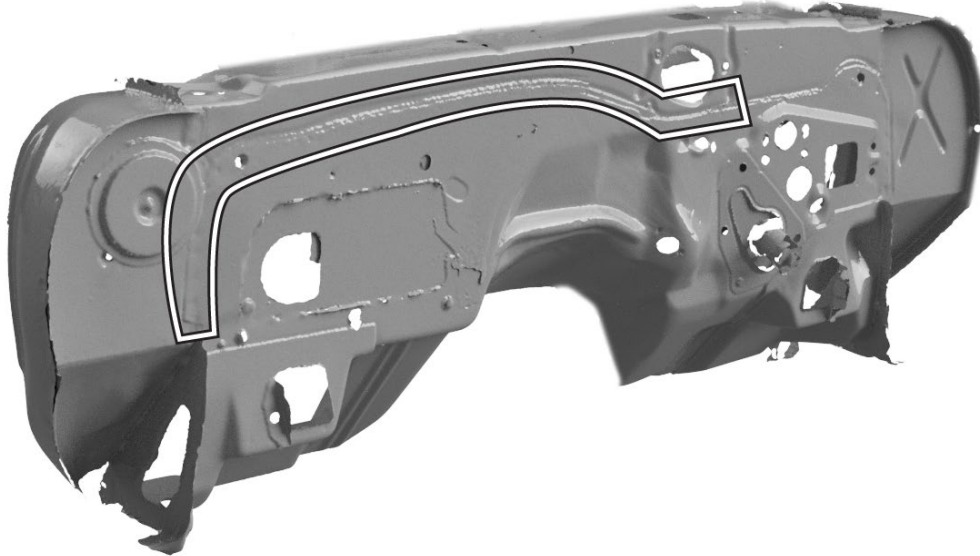

Figure 5: Firewall junction

4.3 CUTTING FIREWALL

Proceed to cut along your marked cut lines and remove the old firewall.

5.0 INSTALLATION

[Back to Table of Contents](#)

5.1 MOCK UP - FIREWALL

After the firewall is removed, mock up your new firewall in place. You can hold it with sheet metal screws, clecos, etc.

5.2 MOCK UP - TUNNEL

Mock up the tunnel transition in place and determine your cut lines to remove the front portion of the transmission tunnel. Be sure to leave extra tunnel material to overlap the new transition for easier welding. The floor pan angle will likely need to be massaged more vertically to meet the sides of the transition properly.

NOTE: If you are also installing our ExtReme tunnel cover kit, it will line up with the end of the transition. If you are not, the rearward end of the transition will need to be massaged, hammered, and dollied to match the contour of the factory transmission tunnel.

5.3 WELDING

Proceed to weld the firewall and transition once they are properly in place. You can plug weld some of the predrilled holes to hold things in place while you weld the perimeter. It is anticipated that you will use any or all methods of butt welds, lap welds, and plug welds at the installer's discretion.

To avoid warpage, Speedtech recommends welding small sections at a time. It is best to skip around and taking breaks as needed so the metal does not overheat. Once cooled, grind as needed and complete final body work.

NOTE: Before Speedtech welded this firewall in place, they put a simple horizontal design line in place with a bead roller. You are welcome to do the same to create a design of your choice.



Figure 6: Welding the firewall in place

6.0 CONGRATULATIONS

[Back to Table of Contents](#)

Congratulations on completing your project! We know you will get many years of enjoyment from your project. Please join the group, [Team Speedtech](#), on Facebook. Team Speedtech is a community of customers, dealers, and factory employers that have a passion for pro touring muscle cars and are using Speedtech Performance products. You can ask questions and get advice from the group members and share your experience. Everyone enjoys seeing the videos and pictures during the progress of your project and Speedtech encourages you to share them!

Thank you for choosing Speedtech Performance and entrusting us with your smooth firewall for your custom muscle car.

Speedtech Performance, LLC
4160 S. River Rd.
St George UT, 84770
(435) 628-4300